

THE 67th TORONTO INTERNATIONAL BOAT SHOW  
 January 18-26, 2025  
 ENERCARE CENTRE

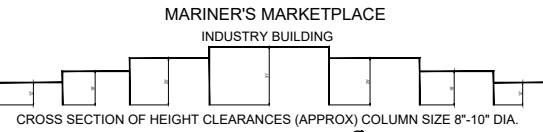

RICOH COLISEUM  
 COTTAGE COUNTRY  
 CEILING HEIGHT EAST ANNEX = 12'-6"

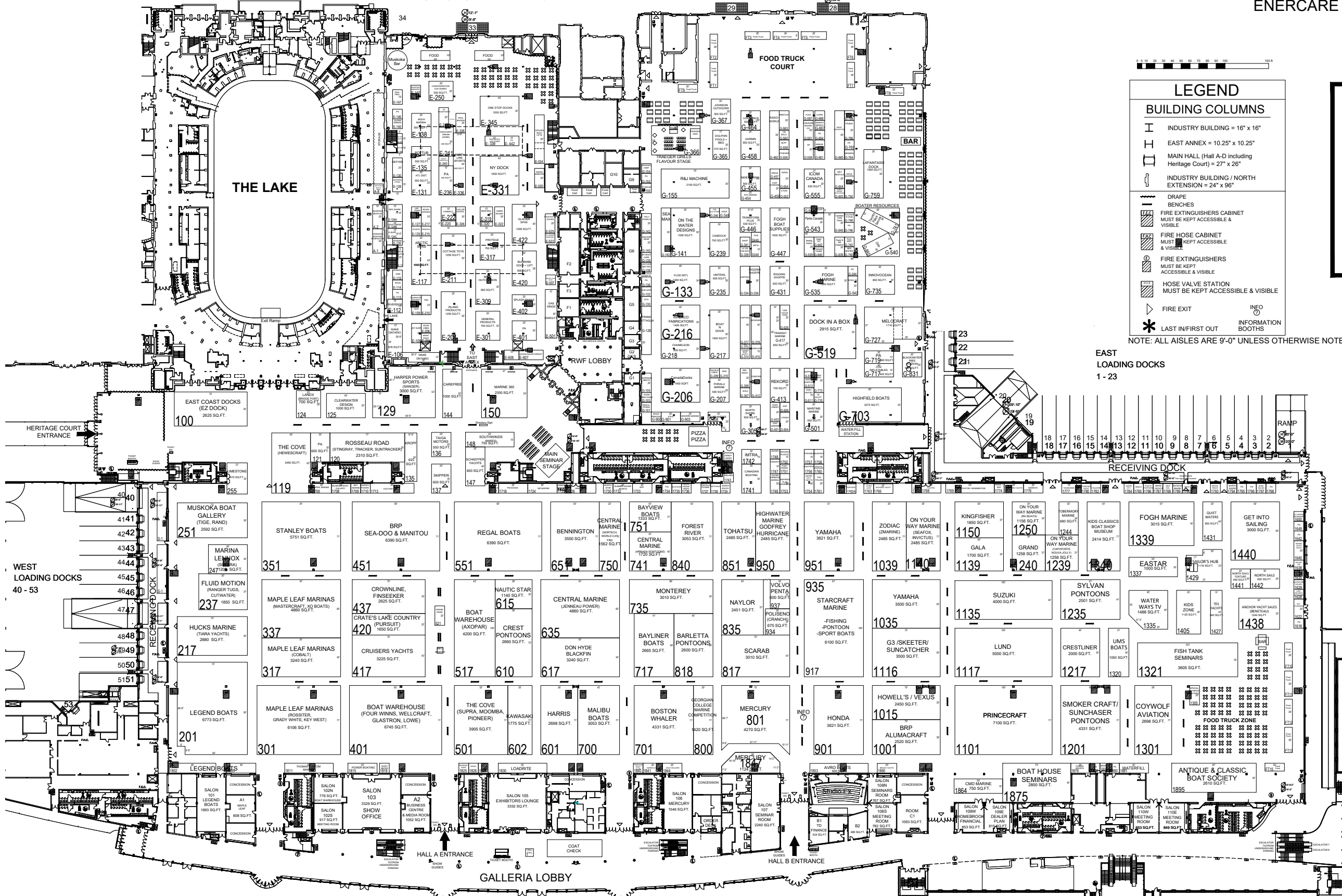

### LEGEND

#### BUILDING COLUMNS

- I INDUSTRY BUILDING = 16" x 16"
- H EAST ANNEX = 10.25" x 10.25"
- MAIN HALL (Hall A-D including Heritage Court) = 27" x 26"
- INDUSTRY BUILDING / NORTH EXTENSION = 24" x 96"

- DRAPE
- BENCHES
- [Symbol] FIRE EXTINGUISHERS CABINET MUST BE KEPT ACCESSIBLE & VISIBLE
- [Symbol] FIRE HOSE CABINET MUST BE KEPT ACCESSIBLE & VISIBLE
- [Symbol] FIRE EXTINGUISHERS MUST BE KEPT ACCESSIBLE & VISIBLE
- [Symbol] HOSE VALVE STATION MUST BE KEPT ACCESSIBLE & VISIBLE
- [Symbol] FIRE EXIT
- [Symbol] LAST IN/FIRST OUT
- [Symbol] INFO INFORMATION BOOTHS

NOTE: ALL AISLES ARE 9'-0" UNLESS OTHERWISE NOTED.

The Floorplan layout and exhibiting companies in each space reflect the final 2024 show. Following the renewal process with prior year exhibitors, open spaces will be re-allocated to returning and new exhibitors.

EAST LOADING DOCKS  
 1 - 23

WEST LOADING DOCKS  
 40 - 53

CEILING HEIGHT MAIN HALL(A-D) = 47', 55', 47'