

THE 54TH TORONTO INTERNATIONAL BOAT SHOW
 PREVIEW NIGHT - JANUARY 13, 2012
 GENERAL SHOW - JANUARY 14 - 22, 2012
 DIRECT ENERGY CENTRE

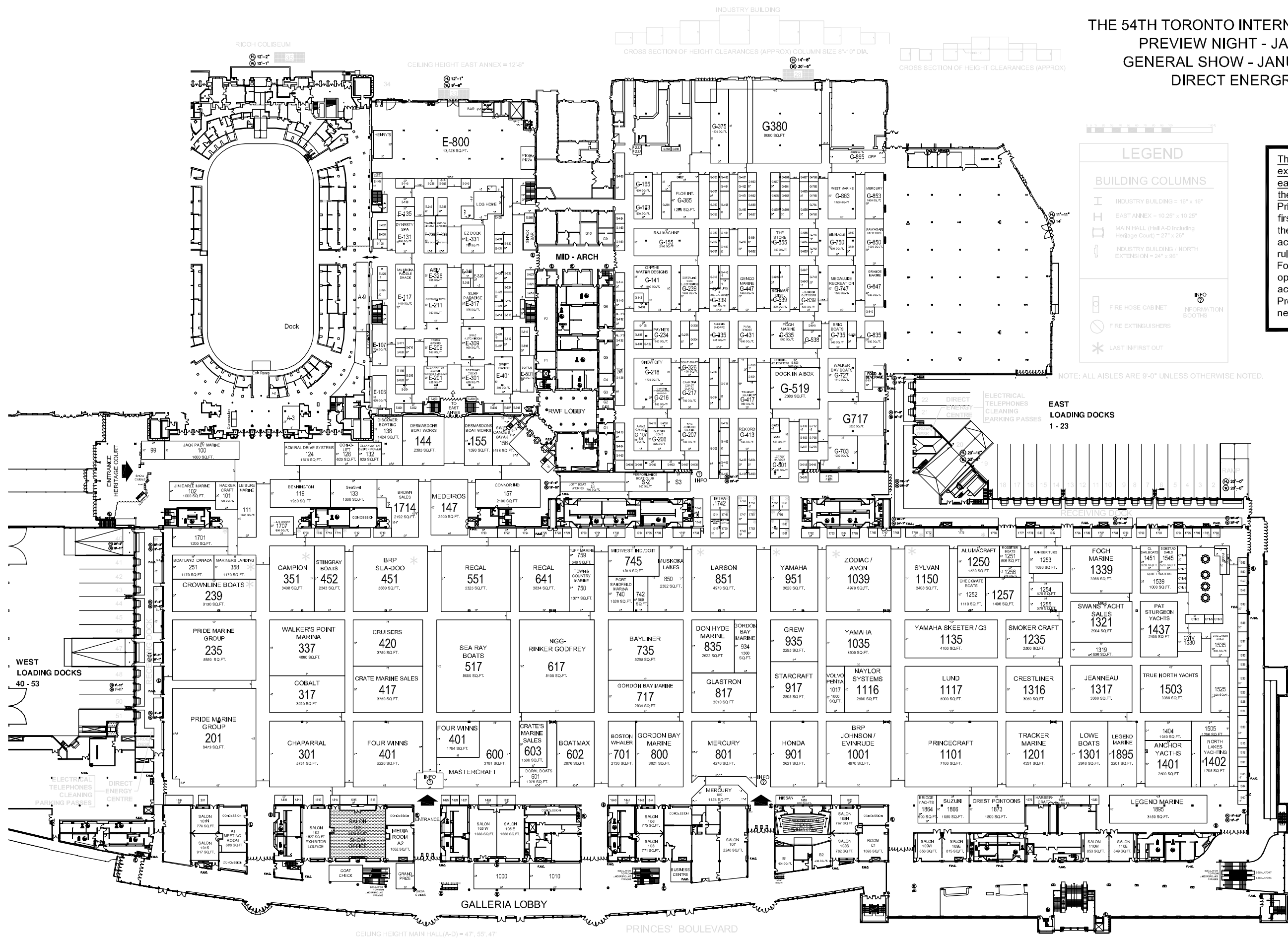

LEGEND

BUILDING COLUMNS

- I INDUSTRY BUILDING = 18" x 10"
- H EAST ANNEX = 10.25" x 10.25"
- MAIN HALL (H&A-D) including Heritage Court = 27" x 26"
- INDUSTRY BUILDING / NORTH EXTENSION = 24" x 96"

INFO

- INFORMATION BOOTHS
- FIRE HOSE CABINET
- FIRE EXTINGUISHERS
- * LAST IN FIRST OUT

The floorplan layout and exhibiting companies in each space reflect the final 2011 show. Prior year exhibitors have first right of refusal on the spaces they occupied, according to CBSI rules and regulations. Following the renewal process, open spaces will be allocated according to the Allocation Procedures for returning and new exhibitors.

NOTE: ALL AISLES ARE 9'-0" UNLESS OTHERWISE NOTED.